

# B&D Black & Decker®

## OWNER'S MANUAL

### SAFETY RULES FOR POWER TOOLS

1. KEEP WORK AREA CLEAN. Cluttered areas and benches invite accidents.
2. AVOID DANGEROUS ENVIRONMENT. Don't expose power tools to rain. Don't use power tool in damp or wet locations. And keep work area well lit.
3. KEEP CHILDREN AWAY. All visitors should be kept safe distance from work area.
4. STORE IDLE TOOLS. When not in use, tools should be stored in dry, high or locked-up place—out of reach of children.
5. DON'T FORCE TOOL. It will do the job better and safer at the rate for which it was designed.
6. USE RIGHT TOOL. Don't force small tool or attachment to do the job of a heavy duty tool.
7. WEAR PROPER APPAREL. No loose clothing or jewelry to get caught in moving parts. Rubber gloves and footwear are recommended when working outdoors.
8. USE SAFETY GLASSES with most tools. Also face or dust mask if cutting operation is dusty.
9. DON'T ABUSE CORD. Never carry tool by cord or yank it to disconnect from receptacle. Keep cord from heat, oil and sharp edges.
10. SECURE WORK. Use clamps or a vise to hold work. It's safer than using your hand and it frees both hands to operate tool.
11. DON'T OVERREACH. Keep proper footing and balance at all times.
12. MAINTAIN TOOLS WITH CARE. Keep tools sharp at all times, and clean for best and safest performance. Follow instructions for lubricating and changing accessories.
13. DISCONNECT TOOLS. When not in use, before servicing; when changing accessories such as blades, bits, cutters, etc.
14. REMOVE ADJUSTING KEYS AND WRENCHES. Form habit of checking to see that keys and adjusting wrenches are removed from tool before turning it on.
15. AVOID ACCIDENTAL STARTING. Don't carry plugged-in tool with finger on switch. Be sure switch is off when plugging in.
16. OUTDOOR USE EXTENSION CORDS—When tool is used outdoors, use only extension cords suitable for use outdoors and so marked.
17. DO NOT OPERATE portable electric tools in gaseous or explosive atmospheres. Motors in these tools normally spark, and the sparks might ignite fumes.

## HEAVY - DUTY ELECTRIC POLISHERS

CAT. NOS. 6128-09, 6130-09, 6132-09, 4100-09

### ADDITIONAL SAFETY RULES FOR POLISHERS

1. Before turning the switch to the "ON" position, be sure the pad is free to revolve.
2. Care must be exercised to prevent accidental power cord-pad contact. Remember that a pad with compound or wax tends to adhere to objects it touches, thus making the pad dangerous when rotating near the power cord. If the cord should be picked up in the pad, immediately shut the tool off and unplug the power cord before attempting to straighten it out. Be sure to examine the power cord for damage such as cuts, abrasions, etc. resulting from the pad contact. If there is damage to the power cord, have it properly repaired at a B&D Service Center or other qualified electrical repair company before using the tool again.
3. Never use a damaged or torn polishing pad or bonnet.
4. Wear proper clothing, short sleeves, nothing loose or bulky such as shop coats, etc.
5. Don't overreach. Use both handles whenever possible.
6. Be extremely careful when polishing around sharp or protruding objects on the car body.
7. Always wear eye protection.
8. Clean your tool out periodically following the procedure in the maintenance section.

### GROUNDING

This tool should be grounded while in use to protect the operator from electric shock. The tool is equipped with an approved three-conductor cord and three-prong grounding type plug to fit the proper grounding type receptacle. The green (or green and yellow) conductor in the cord is the grounding wire. Never connect the green (or green and yellow) wire to a live terminal. If your unit is for use on less than 150 volts, it has a plug like that shown in Figure A. If it is for use on 150 to 250 volts, it has a plug like that shown in Figure D. An adapter, Figures B and C, is available for connecting Figure A plugs to two-prong receptacles. The green-colored rigid ear, lug, etc., must be connected to a permanent ground such as a properly grounded outlet box. No adapter is available for a plug as shown in Figure D. Adapter shown in Figures B & C is not for use in Canada

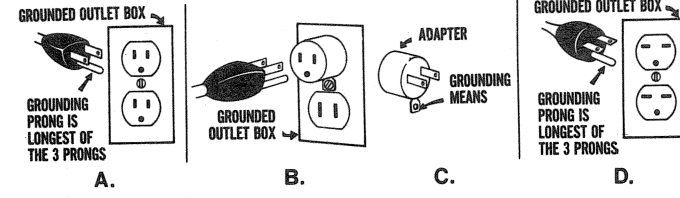

### MOTOR

Your Black & Decker tool is powered by a B&D-built motor. Be sure your power supply agrees with voltage marked on nameplate. **Volts 50/60 Hz** means **Alternating Current only**. **Volts DC-60 Hz** means it will also operate on **Direct Current**. Voltage variation of more than 10% will cause loss of power and over-heating.

### MOTOR BRUSHES

Inspect carbon brushes frequently. Replace when brushes are worn down to the identifying letter or groove or when spring exerts insufficient pressure to hold brush against commutator. Keep brushes clean and sliding freely in guides.

To remove brushes:

1. Disconnect tool from power supply.
2. Remove brush cap and brass insert (Figure 5).
3. Pull brush assembly out of brass insert.

### CAUTION

To assure product SAFETY and RELIABILITY, repairs, maintenance and adjustment should be performed by BLACK & DECKER Service Centers or other qualified service organizations, always using BLACK & DECKER replacement parts.

### CONTROLS

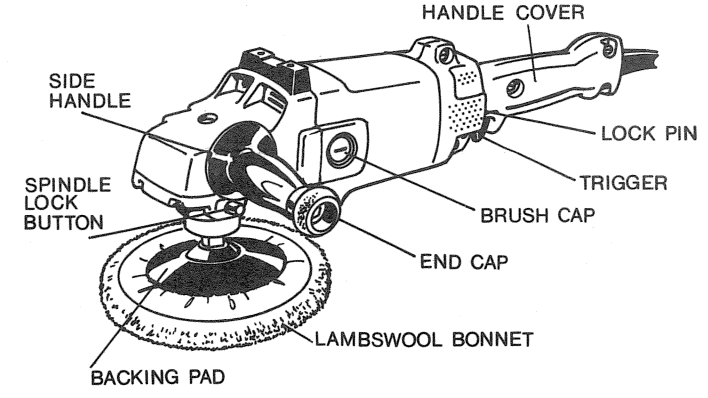

FIGURE 1

**Trigger:** To start tool, depress trigger; to stop tool, release trigger. To lock trigger in "ON" position for continuous operation, depress trigger, push in locking pin and then release trigger. To release locking mechanism, depress and release trigger. **CAUTION:** Grasp tool firmly with both hands before starting tool.

**Side Handle** may be attached to either side of tool for left or right handed operation. To attach Handle, turn **End Cap** to engage the bolt in the threaded hole on either side of the tool. Hold **Side Handle** so that its squared end will properly engage the socket on the side of the tool as the bolt is tightened.

**Spindle Lock Button** is used to lock the spindle when changing accessories. To engage the **Lock Button**: disconnect the tool from the power supply, depress the button, and turn the pad and spindle in a direction **opposite** to its ordinary direction of rotation until **Lock Button** engages spindle.

**NOTE:** Do not depress spindle lock button while unit is running.

### COMMERCIAL / INDUSTRIAL USE WARRANTY

Black & Decker warrants this product for one year from date of purchase. We will repair without charge, any defects due to faulty material or workmanship. Please return the complete unit, transportation prepaid, to any Black & Decker Service Center or Authorized Service Station listed under "Tools Electric" in the yellow pages. This warranty does not apply to accessories or damage caused where repairs have been made or attempted by others.

### IMPORTANT!

To assure product SAFETY and RELIABILITY, repairs, maintenance and adjustment should be performed by BLACK & DECKER Service Centers or other qualified service organizations, always using BLACK & DECKER replacement parts.

### FACTORY SALES & SERVICE CENTERS

Area Code	Area Telephone No.
ALABAMA	... Birmingham 85829, 15, Union Springs Highway 205 244-1888
ARIZONA	... Phoenix 80024, 537 E. Camelback Road 602 246-1332
ARKANSAS	... Little Rock 72201, 519 West Seventh Street 501 372-3640
CALIFORNIA	... Anaheim 92802, 1225 So. Euclid Ave. 714 774-4699
	... Los Angeles 90027, 2452 S. Broadway (Sales only) 213 749-6371
	... Los Angeles 90007, 2915 S. Broadway (Sales only) 213 749-7638
	... Long Beach 56002, 4010 Merrill, 15206 E. 14th St. 562 434-3282
	... Sacramento 95814, 1915 Seventeenth Street 916 444-3188
	... San Diego 62202, 2222 Camino del Rio South 619 439-5930
	... San Francisco 94111, 14920 Victory Blvd. 415 871-7278
	... Van Nuys 91411, 14920 Victory Blvd. 213 797-5531
CONNECTICUT	... Bridgeport 06603, 1085 Lafayette Circle 203 386-3419
	... Hartford 06114, 131 Meadow Street 860 524-4681
DISTRICT OF COLUMBIA	... Washington 20007, 2070 14th St. NE 202 462-1800
FLORIDA	... Jacksonville 32204, 129 Annandale Pk. 904 346-7377
	... Miami 33168, 13342 N.W. Seventh Avenue 305 681-6658
	... Orlando 32805, 940 S. Orange Ave. 407 425-1651
	... Tampa 33604, 303 E. Alafia Ave. 813 838-1177
GEORGIA	... Atlanta 30354, 3271 Hamilton Blvd., S.W. (Sales only) 404 762-1300
	... Atlanta 30308, 2155 Peachtree Street N.W. 404 524-0431
HAWAII	... Honolulu 96813, 975 Aiea Street 808 538-9374
ILLINOIS	... Chicago 60646, Lincolnwood, 6710 N. Crawford St. 312 673-0923
	... Chicago 60643, Oak Lawn, 6343 West 95th St. 312 425-7212
	... Rock Island 61201, 725 30th Street (Sales only) 309 788-1744
INDIANA	... Evansville 47710, 307 First Ave., Crescent Center 812 425-4589
	... Indianapolis 46202, 1125 W. 16th Street 317 632-5569
IOWA	... Des Moines 50312, 2811 Ingraham Street 515 244-7257
	... Des Moines 50312, 2811 Ingraham Street 515 253-6571
KANSAS	... Wichita 67214, 203 N. Mathews Street 316 265-6571
LOUISIANA	... Metairie (New Orleans) 70002, 3310 Causeway Blvd. 504 837-2550
	... Baton Rouge 70801, 203 West 28th Street 504 465-5050
	... Blaineburg (Wash. D.C.) 20710, 4501 Baltimore Ave. 301 779-3668
	... Rockville (Belt) 21084, 201 Elm Pike 301 826-2510
MASSACHUSETTS	... Boston (Brighton) 02135, 12 Market St. 617 752-6264
	... Detroit 48219, 18133 W. McNichols Rd. 313 534-8889
	... Flint 48854, 4483 Chgo Road 313 769-6191
	... Grand Rapids 49509, 3662 Clyde Park Ave., S.W. 616 934-9191
MINNESOTA	... Bloomington (Mneapolis St.) 55420 612 851-1111
	... Kansas City 64111, 4324 Main St. 816 531-0633
MISSOURI	... Kansas City 64111, 4324 Main St. 816 531-0633
	... St. Louis 63110, 615 S. Vandeventer Ave. (Sales only) 314 532-2210
	... St. Louis 63110, 615 S. Vandeventer Ave. (Sales only) 314 291-2772
NEBRASKA	... Omaha 68102, 2218 Leavenworth Street 402 345-2330
NEW YORK	... New York 10014, 227 Madison St. (Manhattan) 212 335-1042
	... New York 11377, 5615 Queens Blvd. (Woodside) 212 335-1042
	... New York 11364, 1059 Old Country Rd. (L.I.) 516 997-6140
	... Westbury 11590, 1059 Old Country Rd. (L.I.) 516 997-6140
	... Syosset 11787, 2140 Elm Blvd. S. 516 348-1621
NORTH CAROLINA	... Charlotte 28206, 1710N. Graham St. 704 252-5751
	... Greensboro 27403, 1010 W. Lee Street 919 274-9965
	... Raleigh 27604, 2420 Atlantic Avenue 919 839-8007
	... Charlotte 28202, 1240 East Blvd. E. 704 252-5751
OHIO	... Cleveland 44113, 3901 Detroit Ave. 216 651-4243
	... Columbus 43227, 2975 E. Livingston Ave. 614 237-0461
	... Toledo 43607, 231 Dor St. 419 531-8921
OKLAHOMA	... Oklahoma City 73106, 1318 Linwood Blvd. 405 235-7515
	... Tulsa 74146, 3120 South Sheridan Road 918 424-9265
PENNSYLVANIA	... Allentown (Whitehall) 18052, 17115 5th Street 610 492-9444
	... Harrisburg 17119, 2542 MacArthur Rd. 717 732-1221
	... Philadelphia 19103, 352 No. 20th Street (Sales only) 215 554-9521
	... Philadelphia 19103, 352 No. 20th Street (Sales only) 215 554-9521
	... Wayne 18071, 225 Stratford Avenue 412 362-2700
RHODE ISLAND	... Providence 02914, 277 Pawtucket Ave. 401 332-9855
	... Providence 02914, 277 Pawtucket Ave. 401 332-9855
TENNESSEE	... Knoxville 37917, 4110 North Broadway 615 688-0921
	... Memphis 38116, 988 East Brooke Rd. 901 392-3444
	... Memphis 38116, 988 East Brooke Rd. 901 392-3444
	... Dallas 75207, 1808 N. Industrial Blvd. (Sales only) 214 741-6401
	... El Paso 79925, 1400 North Sweeney (Sales only) 915 778-9769
	... Fort Worth 76103, 1801 Bonner Street 817 336-0175
	... Houston 77050, 500 Condit Avenue 713 729-1221
UTAH	... Salt Lake City 84116, 1541 S. Third West Street 801 486-7056
	... Utah 84116, 1541 S. Third West Street 801 486-7056
	... Norfolk 47024, 129 Augustine Road 757 633-1177
VIRGINIA	... Falls Church 22046, 1424 Chambers Road Ave. 703 282-6432
	... Richmond 23222, 1424 Chambers Road Ave. 804 649-9245
WASHINGTON	... Seattle 98109, 701 Third Ave., N. 206 282-6432
	... Spokane 99207, 3550 North Merit Street 509 489-9164
	... Spokane 99207, 3550 North Merit Street 509 489-9164
WISCONSIN	... Milwaukee (West Allis) 53227, 594 W. James St. 414 543-9590
	... Milwaukee 10903, W. Lincoln Ave. 414 543-9590

## THE BLACK & DECKER MFG. CO., TOWSON, MD. 21204, U.S.A.

FORM NO. 722054-02

(Nov.76-PS) Printed in U.S.A.

+

+

+

## ATTACHING PADS

**BE SURE THE TOOL IS UNPLUGGED!** Push the hub of the clamp washer through the hole in the center of the Lambswool Pad as far as it will go. Engage the hexagonal Clamp Washer hub with the hexagonal hole in the Backing Pad (Fig. 2). Holding the three pieces firmly together, place the assembly on the tool spindle. Hold the spindle lock button while turning the pads clockwise to thread them completely on the spindle (Fig. 3).

To remove pads, turn them by hand in the opposite direction from normal rotation to allow lock button to engage spindle, then unscrew pads in normal direction for right hand thread.

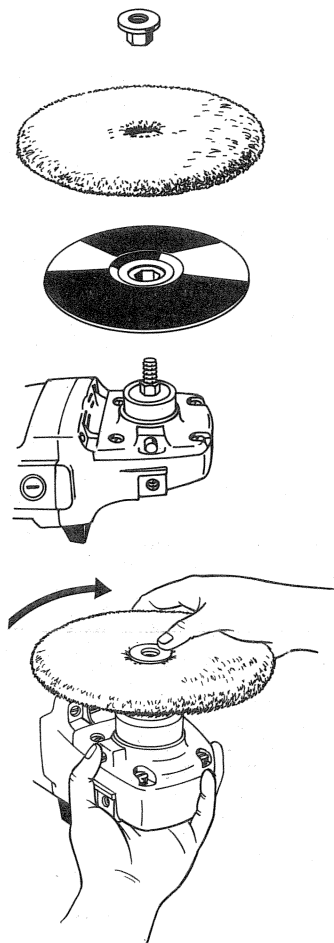

FIG. 2

FIG. 3

## GENERAL OPERATION—continued

Without turning tool "ON", grasp the handles of the tool and pick it up. Keep the tool away from your body and turn the switch "ON". Make sure you have a firm grip on the handles and operate the tool freely without forced effort or unnecessary pressure. The side handle can be easily changed to either side of the tool for left-hand or right-hand operation.

## POLISHING

Spread a light coat of a good grade of polish, with a soft clean cloth or brush, over a small area and apply the Polisher before the polish dries. When starting to polish, it is all right to have the Polishing Pad resting squarely on the surface, but as the scum and film begin to work loose, start tilting the tool so that the dry outer section of the Polishing Pad comes in contact with the surface. If hazy spots still remain, apply a little more polish and work out these spots.

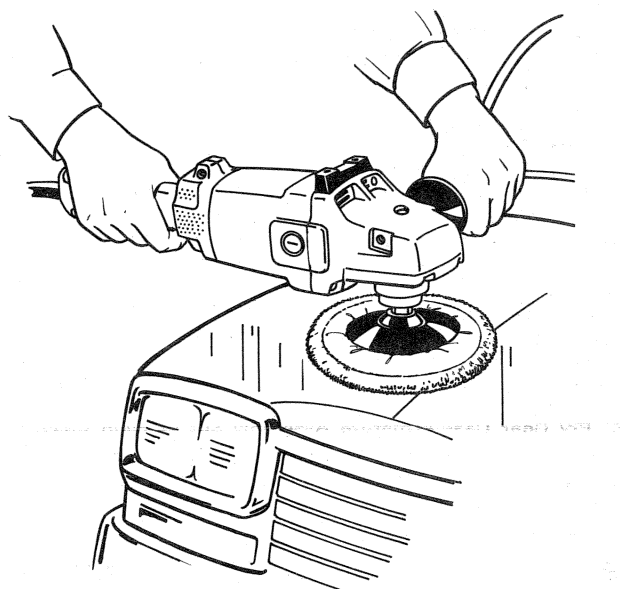

Start polishing with the roof, move to the hood, the fenders, the doors, etc. In this way, the slight dust that may be thrown off into the air by the revolving pad will not fall on completed sections, and the power cord will not be dragged over completed portions. When the car has been completely polished, an additional high lustre may be obtained if a few drops of water are sprinkled on the surface and gone over quickly with the Polisher or a clean dry cloth. (If a cloth is used, it is not necessary to rub—merely wipe.)

A Polishing Pad will become discolored with use because it has picked up "dead" pigment from the car surface. Excess dirt on the pad can often be removed by lightly touching the pad to an edge of the car bumper while pad is rotating. (The edge of a work bench or garage door will serve the same purpose.) When the pad becomes very dirty, remove it from the tool and dip the wool part only (do not get the back of the pad wet) into a pail of clean water, scuffing the pad with your hand. Put pad back on polisher and spin it dry.

## CLEANING COMPOUNDS

The general procedure for using cleaning compound is similar to that used for polishing. Spread a light coat of a good grade of compound on the surface with a clean cloth or brush and apply the Polisher. Best results are obtained when the unit is operated with the pad at a slight angle to the work surface. Care should be taken in the amount and coarseness (light, medium or heavy) of the compound used and the speed and pressure exerted on the work surface. (See General Operating Instructions.)

## GENERAL OPERATION

These instructions and suggestions are intended to familiarize new operators in overall general operation of POWER POLISHING. You will develop your own techniques which will make the job easier and faster as you learn power polishing.

As mentioned previously you should use utmost care when power polishing around or over sharp objects and contours of the car body. It is very important to use the correct pressure while polishing various sections of an automobile body. For example, light pressure should be applied when polishing over sharp raised edges of body panels, or over edges of the rain gutter along the top.

Since everyone does not use the same type of Power Polish, we recommend you clean and polish a test section on a flat area of the car **FIRST**. From this test section, you can judge the strength or cleaning action of your Power Polish.

Remember, all Power Polish is not the same. Different brands will react differently on various painted surfaces. Also, you are now using a POWER POLISHER with Power Polish. This is entirely different from any hand application which you may have done before. Wash the car before power polishing it. Washing will remove loose dirt, scum, road salt, etc. which could act as an abrasive and damage the paint. Loose dirt, etc. will also clog the polishing pad and you will have to clean it more often.

## MAINTENANCE

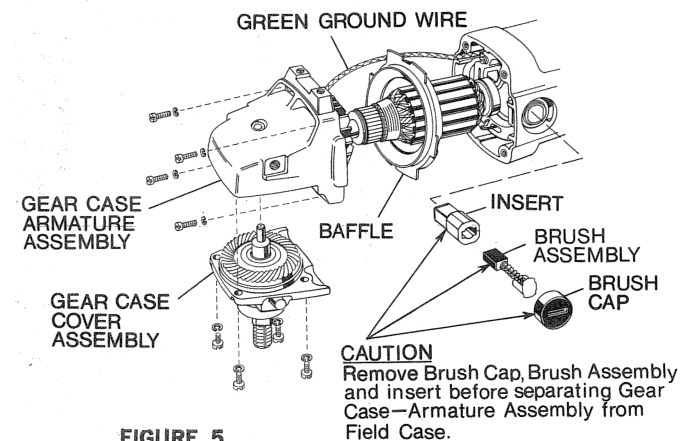

FIGURE 5

To assure product safety and reliability, repairs, maintenance and adjustment should be performed by Black & Decker Service Centers or other qualified service organizations, always using Black & Decker replacement parts.

### Cleaning:

The air intake openings in the handle should be kept free and clear of dust and dirt by blowing through them occasionally with an air hose. If more thorough cleaning within the motor housing is required, follow the disassembly procedure outlined below.

**CAUTION:** Never use solvents or other harsh chemicals for cleaning the non-metallic parts of the tool. Use clean, dry rag only.

### Disassembly of Unit for Cleaning

1. Disconnect tool from power supply.
2. Remove handle cover.
3. Remove Brush Caps, Brush Assemblies and Brass Inserts.
4. Remove the (4) screws holding the Gear Case-Armature Assembly to the Field Case.
5. Pry Gear Case-Armature Assembly out of Field Case.
6. Remove Gear Case-Armature Assembly from Field Case avoiding force when pulling green Ground Wire through Field Case. Guide green Ground Wire on handle end of Field Case as required.

### Assembly Procedure

1. Ground Wire must be securely connected to the Gear Case-Armature Assembly.
2. Position Baffle in the Field Case.
3. Pull green Ground Wire on handle end of Field Case while Gear Case-Armature Assembly is inserted into Field Case. No slack wire may remain in the Gear Case or the Field Case.
4. Tuck excess Ground Wire into space between Field Case and Handle.
5. Replace Gear Case-Armature Assembly mounting screws (4).
6. Replace Handle Cover.
7. Replace Brass Inserts, Brush Assembly and Brush Caps.

### Brushes:

Inspect carbon brushes often. Replace when brushes are worn down to the identifying groove or when spring exerts insufficient pressure to hold brush against commutator. Keep brushes clean and sliding free in guides.

### To remove brushes:

1. Disconnect tool from power supply.
2. Remove Brush Cap and brass insert.
3. Pry sheet metal cap on Brush Assembly out of brass insert.

### Lubrication:

Except for the needle roller bearings used at the upper end of the spindle, closed-type, grease-sealed ball bearings are used throughout. These bearings have sufficient lubrication packed in them at the factory to last the life of the bearing. The needle bearings mentioned above receive their lubrication from the grease in the gear case. Gears should be lubricated every 60 to 90 days in accordance with the following procedure:

1. Remove the (4) Screws and pry the Gear Case Cover Assembly from the Gear Case-Armature Assembly.
2. Wipe out old grease from Gear Case and Cover.
3. Place 3 oz. Black & Decker lubricant (Cat. 60541) on top of gear.
4. Re-assemble Gear Case Cover Assembly to Gear Case-Armature Assembly carefully so that Gear meshes properly with Pinion.

## ACCESSORIES:

**CAUTION:** Accessories shown on this page are recommended for use with your Polisher. The use of any other accessory might be hazardous.

### Random Orbit Buffer Head

#63313 Random Orbit Head assembly is available as a separate attachment, complete with one bonnet, as an accessory to fit any standard automotive polisher having a 1/8"-11 thread. Use it to convert your present polisher to a Random Orbit Buffer. **CAUTION:** Do not use this accessory on tools with speeds that will exceed 3,000 RPM.

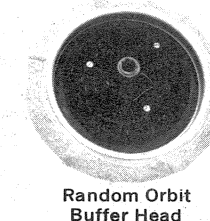

Random Orbit Buffer Head

### Rubber Backing Pads

#50934 7" Quick-Change Flexible Backing Pad. Includes #50933 Clamp Washer; attaches same as #51824 Pad below.  
#51824 7" Quick-Change Super Flexible Rubber Backing Pad with #50933 Clamp Washer. Washer is threaded inside; fits through hub of pad, and threads onto spindle of polisher.



Rubber Backing Pad

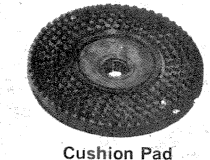

Cushion Pad

#36239 7" Cushion Pad with #45925 Clamp Washer. A superior cushioning pad for use with Vitri-Buff Bonnets. Threads directly on polisher spindle.

### Lambswool Bonnets and Pads

Made of high quality lambswool skins. Economically priced.

#13086 7" Lambswool Polishing Pad. Use with #51824 Quick-Change Super Flexible Rubber Backing Pad.

#13087 7" Lambswool Polishing Bonnet with hood and drawstring. Use with #51824 Quick-Change Super Flexible Rubber Backing Pad.  
#22176 9" Lambswool Polishing Bonnet with hood and drawstring. Use with #36239 Cushion Pad.

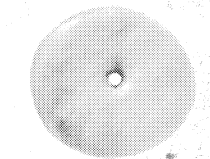

Lambswool Bonnet

### Vitri-Buff Bonnets and Pads

Gives a superior shine on all car finishes. Each tuft is twisted and locked to backing pad by patented construction method. Very resilient, stronger pile, more body. Outlasts other buffs many times over.

#45434 7 1/2" Vitri-Buff Pad.  
#37796 7 1/2" Vitri-Buff Bonnet with hood and drawstring. Use with #51824 Quick-Change, Super Flexible Rubber Backing Pad.

#37797 9" Vitri-Buff Bonnet with hood and drawstring. Use with #36239 Cushion Pad.

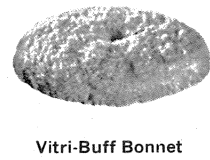

Vitri-Buff Bonnet

### Clamp Washers

#50933 Replacement Clamp Washer. Inside-threaded; fits through hub of #51824 and #50934 Quick-Change Flexible Backing Pads and threads onto spindle.

#45925 Replacement Clamp Washer. Outside-threaded. Use with #36239 Cushion Pad.

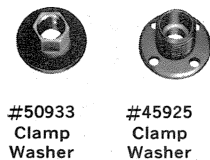

#50933  
Clamp  
Washer

#45925  
Clamp  
Washer

### Power Polish #48428

Formulated for one-operation cleaning and polishing with power polishers. Leaves clean lustrous, sealed surface that stays hard and bright for months. Won't remove or harm live paint. 1/2 gallon.



Power Polish